



# Meta System

## M43J(T) Immobiliser

# Installation and Operating Guide V2.2

17/02/20





## Table of Contents

<b>KIT CONTENTS</b>	<b>3</b>
<b>ELECTRICAL CHARACTERISTICS</b>	<b>3</b>
<b>OPERATION</b>	<b>4</b>
MANUAL MODE	4
AUTOMATIC (Proximity) MODE	4
<b>VALET MODE</b>	<b>5</b>
<b>Service Key Receptacle Installation</b>	<b>5</b>
<b>WIRING DIRECTIONS and PRECAUTIONS</b>	<b>6</b>
<b>WIRING DIAGRAM</b>	<b>7</b>
<b>Check Service Key and ID-Tag Operation</b>	<b>8</b>
<b>Finalising the Installation</b>	<b>8</b>
<b>Replacement ID-Tag Programming</b>	<b>9</b>
<b>TROUBLESHOOTING</b>	<b>10</b>
<b>Dealer Support</b>	<b>10</b>

## KIT CONTENTS



**X1**

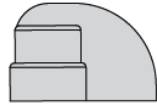

**X1**



**X2**



**X2**



**X1**



**X2**

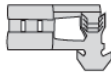

**X4**

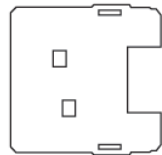

**X2**



**X1**



**X1**



**X1**



**X1**



**X4**



**X2**



**X2**



**X2**

## ELECTRICAL CHARACTERISTICS

Operating Voltage M43J 12v Version 12V (9-15V)

Operating Voltage M43J 24v Version 24V (18-30V)

Current consumption (Ign. OFF) <3mA

Relay Current Rating (Wires 7+8) 8A

Relay Configuration Normally Open

Relay Current Rating (Wires 4+5) 10A

Relay Configuration Normally Open (in-built Fail-Safe circuitry)



## OPERATION

### MANUAL MODE

#### ARMING:

Approx. 15 seconds after Ignition OFF the immobiliser **will ARM** and the LED will flash **every 2 seconds**.

If the Ignition is switched ON **without pressing the ID-Tag button** the Immobiliser LED will become ON solid to indicate the immobiliser is still armed.

#### DISARMING:

Once inside the vehicle **press the button of the ID-Tag** and start the vehicle **within 8 seconds**; the immobiliser LED will flash twice and then extinguish.

### AUTOMATIC (Proximity) MODE

In Automatic mode the button of the ID-Tag will flash briefly once every 5 seconds.

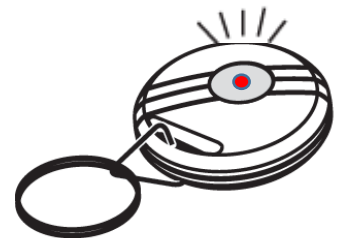

#### ARMING:

Approx. 15 seconds after Ignition OFF and the ID-Tag out of range\* the immobiliser **will ARM** and the LED will flash **every 2 seconds**.

*\*In any case, the **ID-Tag will be switched off after 20mins** if it is not in motion. As soon as the ID-Tag detects movement it will automatically switch ON again.*

If the Ignition is switched ON **without the ID-Tag** present the immobiliser LED will be ON solid

#### DISARMING:

Simply start the vehicle as normal, the ID-Tag will automatically be detected; the immobiliser LED will flash twice and then extinguish.



## VALET MODE

### (Non-Insurance Installations Only)

To set the immobiliser into Valet mode insert the service key into the receptacle momentarily; the LED will give one long flash to confirm.

The immobiliser will now remain in a disarmed state until the service key is used again. Thereafter, the immobiliser will return to automatic arming mode.

## Service Key Receptacle Installation

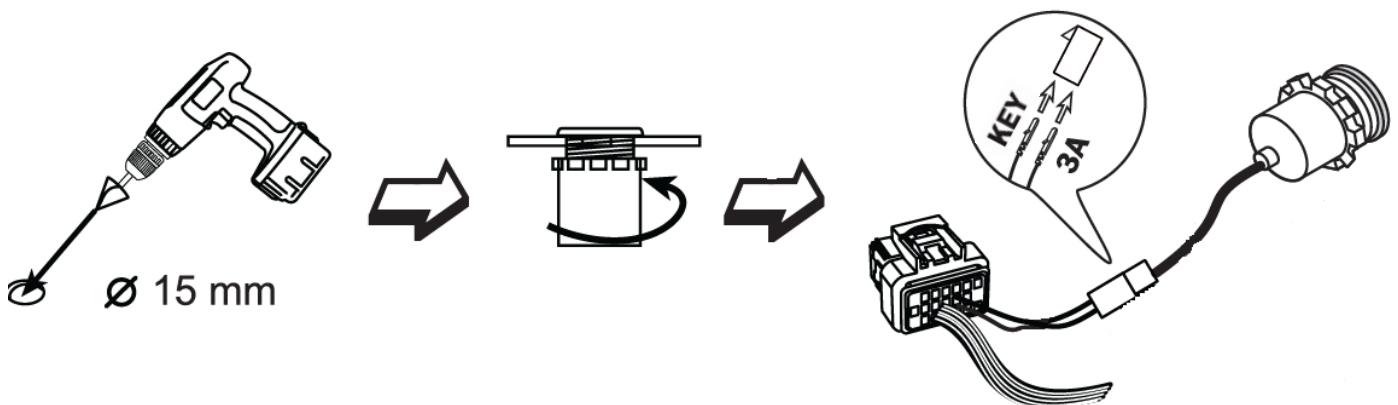

For Non-Insurance installations install the receptacle in a location accessible to customer in order allow use of the service key for Valet mode.

### NOTE: For THATCHAM CAT2 Installations

The receptacle **MUST NOT** in mounted in a location accessible to the customer; Valet mode is not allowed. Attach the receptacle to the wiring harness in a way that it can be accessed by a dealer for future ID-Tag programming.



## WIRING DIRECTIONS and PRECAUTIONS

- 1 Connect to **IGNITION** (+15) via the supplied fuse and holder.  
ENSURE the ignition remains live whilst cranking
  
- 2 Connect to Permanent **POSITIVE** (+30) via the supplied fuse and holder.
  
- 3 } Connect to **GROUND** (-31)
- 3B } Connect to a different **GROUND** (-31) point
  
- KEY } See Diagram on next page
- 3A }
  
- LED } Connect to RED/BLACK of **LED**
- 3C } Connect to BLACK of **LED**

### RELAY 1

- 4 Connect to **SUPPLY side** of cut (fuel pump, ignition relay etc)
- 5 Connect to **LOAD side** of cut (fuel pump, ignition relay etc)
- 6 Not Used

*NOTE: Do not cut a permanent live circuit; cutting a negative control circuit is possible if required.*

### RELAY 2

- 7 Connect to **SUPPLY side** of **STARTER** cut
- 8 Connect to **LOAD side** of **STARTER** cut
  
- 10 Not Used

**ANT** The majority of the wire can be taped into the wiring loom; ensure the last 24cm is free.

# WIRING DIAGRAM

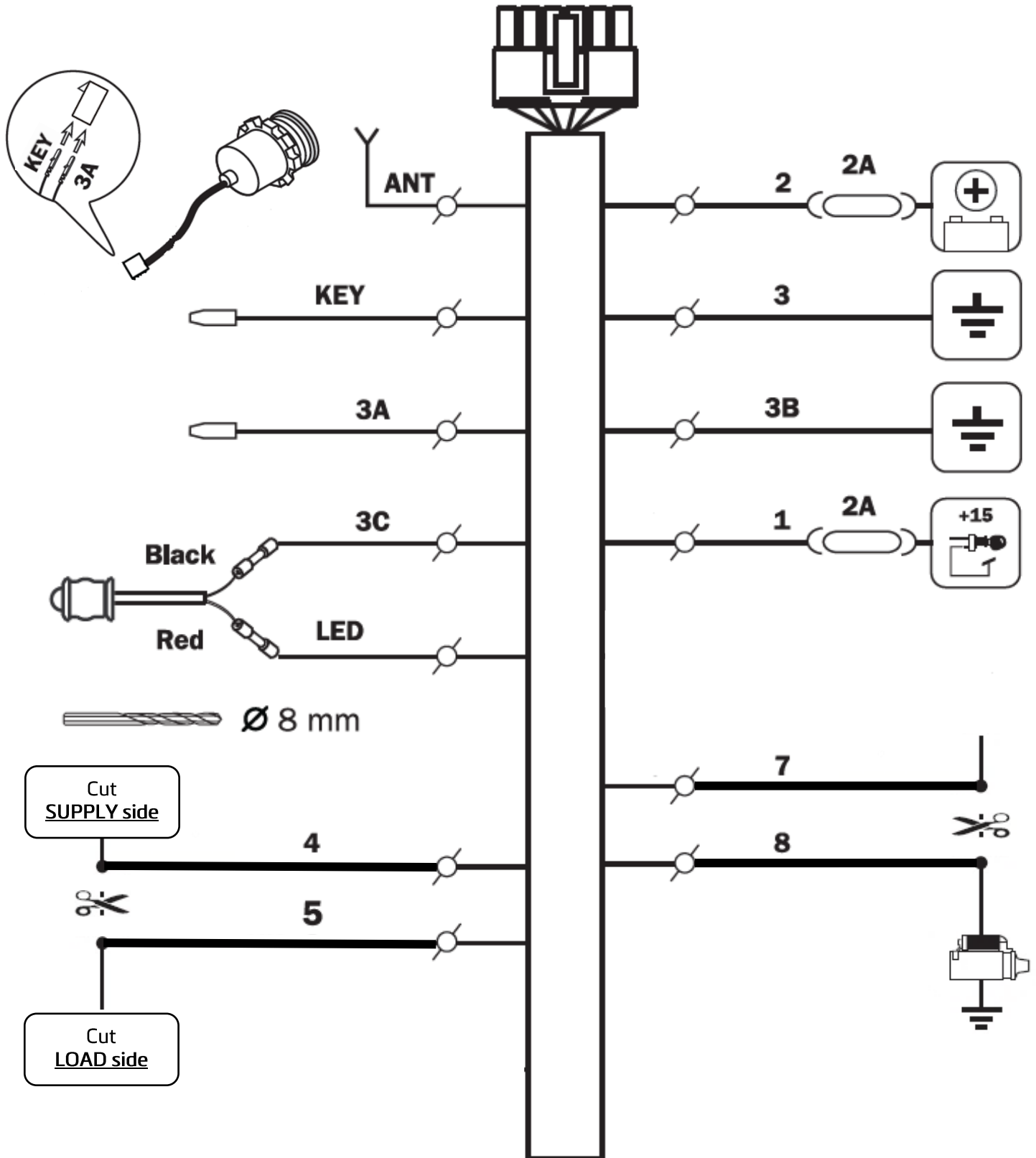



## Check Service Key and ID-Tag Operation

1. With the ignition OFF and the immobiliser armed, insert the Service Key into receptacle momentarily; the LED will give one long flash.
2. Press the button of the first ID-Tag and check the immobiliser LED flashes once.
3. Repeat for the second ID-Tag.
4. Insert the service key a second time and check the immobiliser arms after 15 seconds.
5. Finally, test the operation of the immobiliser according to the selected operation type; see page 'OPERATION'.

## Finalising the Installation

After completing the installation and successfully testing the operation, fit the connector cover firmly into place.

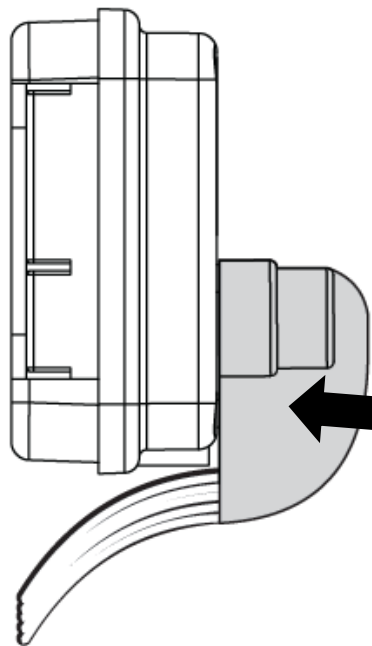





## Replacement ID-Tag Programming

**NOTE:** When adding a new ID-Tag all existing ID-Tags must also be reprogrammed.

### Preparing the ID-Tags for programming:

**New ID-Tags:** Ensure the ID-Tags are not flashing; if they are then follow the instructions for 'Existing ID-Tags'.

**Existing ID-Tags:** Remove the ID-Tag battery for 5 seconds then re-insert.

### Programming ID-Tags

1. Insert and hold the Service Key into the receptacle until the immobiliser LED starting flashing rapidly; approx. 10 seconds.
2. Press and hold the ID-Tag button until the ID-Tag LED becomes solid then release; approx. 10s. The immobiliser LED with go solid for 10s to confirm programming of the ID-Tag.

Repeat for each ID-Tag (up to max. 4).

3. To exit programming mode insert the Service Key momentarily.
4. Within 15 secs (before the immobiliser arms) you can check the ID-Tags are programmed correctly by pressing the button, the Immobiliser LED should illuminate briefly with each press.

**NOTE: After programming ID-Tags they will be in AUTOMATIC mode!**

If you require the ID-Tags to operate in **MANUAL mode**, simply remove the battery for 5 seconds and re-insert; the ID-Tag is now in MANUAL mode.



## TROUBLESHOOTING

### The Immobiliser clicks when trying to start the vehicle:

- a. Ensure the wires 'KEY' and '3A' have been inserted into the 2-way connector supplied.
- b. Ensure the ignition connection is not on the dead side of the cut i.e. it must remain live when the cut is open.

### The Immobiliser does not ARM:

- a. Ensure the immobiliser is not in VALET mode; insert the service key to toggle.
- b. With the ignition OFF, ensure wire No. 5 has no residual voltage. If you are unsure try disconnecting the and re-check arming.

## Dealer Support

**+44(0)208 867 2340**

Mon-Fri 9am-5pm for installation support

**[www.vestatec.co.uk](http://www.vestatec.co.uk)**

Distributed in the UK and the Republic of Ireland by:

Vestatec Distribution Limited

Unit 8, The Links

Popham Close

Hanworth

Middlesex TW13 6JE